



SHIRELAND CBSO ACADEMY

PROUDLY PART OF



SIXTH FORM PROSPECTUS

Shireland CBSO Academy Sixth Form will open its doors to Year 12 students for the first time in September 2023.

Find out how to apply for a place at the end of this prospectus.

Contents

- Welcome
- Our Aim
- Our Partnership with the City of Birmingham Symphony Orchestra
- What We Offer
- Musical Experiences
- Outstanding Facilities
- Entry Requirements
- Music A Level
- Music Technology
- Choosing your Subjects
- Your Application Timeline



Welcome

It isn't often that you get to establish a school in collaboration with a world class orchestra; in fact, Shireland CBSO Academy is unique – the first such school in Britain.

Alongside the City of Birmingham Symphony Orchestra (CBSO), we have worked hard over the last four years to make our vision a reality. It is incredibly exciting to be meeting the young people who will go on to become our very first cohort of Year 12 students.

We are proud to be a part of Shireland Collegiate Academy Trust and our students will benefit from the expertise and connections that the Trust brings. From this strong foundation, we will build our own reputation for musical and academic excellence.

Serving Sandwell and the wider West Midlands, Shireland CBSO Academy will be a non-selective state school and Sixth Form that reflects the diversity of our community. It will deliver a broad curriculum and welcome young people of all backgrounds who have a passion or talent for music.

We look forward to meeting you and embarking on this learning journey together.



Sir Mark Grundy

CEO of Shireland Collegiate Academy Trust



David Green

Principal Designate of Shireland CBSO Academy







Our Aim

Our aim is to ensure that the experience our students gain whilst studying at Shireland CBSO Academy Sixth Form is tailored to their specific needs, with an equally strong focus on academic and musical excellence and personal development.

We have high expectations of all of our students. We will provide you with exciting and rewarding enrichment opportunities alongside a traditional curriculum model underpinned by outstanding teaching, excellent pastoral support and unrivalled aspiration. Our students are expected to attend full time, and to utilise the study and social spaces available to them exclusively within the Academy grounds.

Shireland Collegiate Academy Trust has a proven track record of delivering outstanding Sixth Form education. We're committed to continuing the delivery of the highest quality of teaching to ensure all our students reach their potential, utilising the latest technology to enthuse, challenge and inspire our students.

“We are hugely excited to be able to move ahead with our plans for this new specialist music school, which will offer access to music education, regardless of background, in an area where such opportunities are so desperately needed.

The CBSO has a long tradition of innovation in music education and community work. We were the first British symphony orchestra to present concerts for young people and the first to establish a specialist education department and to build a community facility – all of which have allowed us to make a real musical impact on young people and the wider community in the West Midlands. We are delighted to be part of launching an inclusive and nurturing school which will help create the musicians of the future.”

Stephen Maddock OBE

Chief Executive of the City of Birmingham Symphony Orchestra



City of Birmingham
Symphony Orchestra





Our Partnership with the City of Birmingham Symphony Orchestra

The Shireland CBSO Academy is the result of an exciting partnership between Shireland Collegiate Academy Trust and the City of Birmingham Symphony Orchestra.

Shireland Collegiate Academy Trust is a recognised leader in education. Led by Sir Mark Grundy and founded by three-times Ofsted 'Outstanding' Shireland Collegiate Academy, the Trust has a reputation both locally and nationally for being innovative in its teaching methods and using technology to enhance levels of progress.

The academic rigour provided by the Trust will be combined with the musical prowess of the City of Birmingham Symphony Orchestra. The Orchestra presents over 150 concerts every year around the world, regularly collaborating with internationally renowned musicians.

By combining the knowledge and strengths of both organisations as nationally recognised leaders in their respective fields, we believe that our students will receive the best academic and musical education possible. This will provide them with a real and genuine opportunity to achieve musically at an elite and national level.



A woman in a dark suit is sitting on a red upholstered bench in a dark auditorium. The ceiling has a grid of lights, and the overall atmosphere is dimly lit with some spotlights.

What We Offer

Come and join one of the largest sixth form music cohorts in the West Midlands.

We aim to offer a specialist programme, rich in music education and opportunity, which meets the needs and interests of our learners.

All students who choose to study with Shireland Collegiate Academy Trust have access to:

- Brand-new, state-of-the-art facilities
- Dedicated study and social spaces
- The latest technology, including their own laptop device complete with industry-leading software
- Our online platform of study resources
- Bespoke pastoral and wellbeing provision
- An extensive enrichment programme, which supports students to further develop their skills, qualities and attributes ready for entry into higher education or the world of work

Through our partnership with the CBSO, students who study at Shireland CBSO Academy will also have access to opportunities including:

- Tuition in their chosen instrument(s)
- Music theory tuition
- An on-site, state-of-the-art auditorium
- Brand-new rehearsal spaces
- Recording studio
- Performance opportunities
- Masterclasses from world-renowned musicians
- Bespoke enrichment and career opportunities through the CBSO

Musical Experiences

Students will be immersed in musical experiences throughout their time at the Academy, both inside and outside the classroom.

In addition to curriculum delivery, students will have the opportunity to practise, rehearse and perform together, developing transferable skills that will support them to achieve academic and musical excellence as they grow to become confident and empathetic people.





The range of musical opportunities and experiences will include:

- Instrumental or vocal lessons for all students
- Support with graded practical and theory examinations
- Visits to Symphony Hall to see the CBSO perform
- Regular visits to the Academy by members of the CBSO and other music-industry professionals, who will lead workshops on key skills and techniques
- Opportunities for individuals and groups to perform, record and share their music with wider audiences
- An extensive enrichment programme including, for example, instrumental experiences, development of solo and ensemble skills and introduction to a range of musical styles
- Work with professionals to develop a wider understanding of the careers that complement musical performance and composition, gaining access to working environments and equipment

Innovate
Inspire
Collaborate

Outstanding Facilities

The Academy will open its doors to Years 7 and 12 in September 2023 on the site of the former BT building in Providence Place, West Bromwich. The building has been designed to support music education and performance, with careful consideration given to the acoustic requirements of such a specialist venue.

Some of the exceptional facilities that students will enjoy include:

- A large three-storey auditorium
- Specialist music classrooms
- Music practice rooms
- Recording studio
- Drama studio
- Immersive room
- A two-storey atrium serving as our library

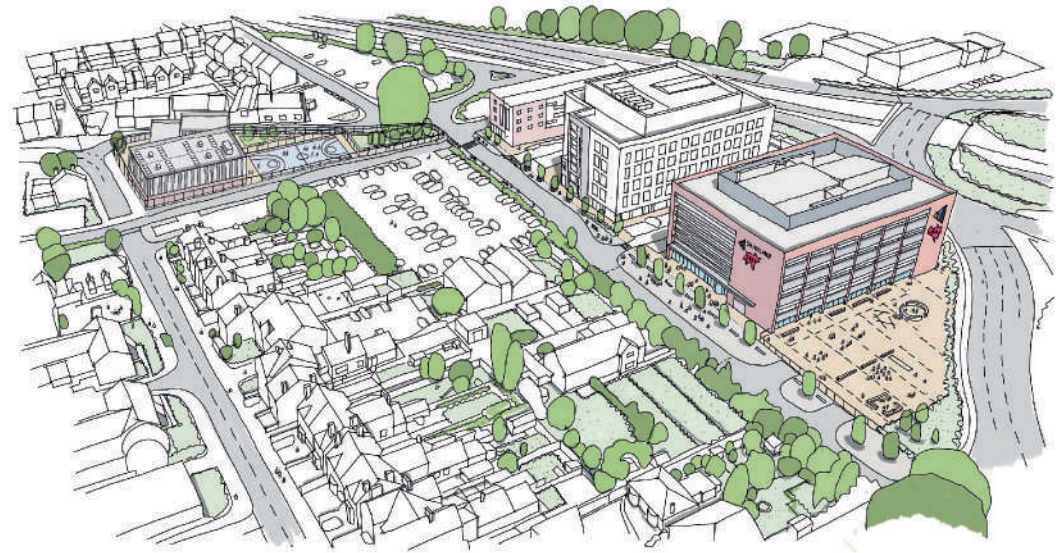



Sport at Shireland CBSO Academy

Our students will have access to our brand-new sports facility, just a few hundred metres away on Sandwell Road which includes an outdoor sports court, indoor sports hall and activity studio.



Entry Requirements

Students are required to have:

- 5 GCSEs or equivalent, including English and Maths, at grade 5 or above
- Minimum of grade 5 or above at GCSE in order to be considered to study a subject at A Level
- Met any additional entry requirements for specific subjects

It is expected that all students attending Shireland CBSO Academy will study at least one Level 3 music qualification and two additional A Level/BTEC courses from the list provided on the next page. We will consider students wishing to study four A level or equivalent qualifications on a case-by-case basis.





Music A Level

A Level music is a rigorous academic subject which equips students with the written, analytical, practical and personal skills which are essential to success. For this reason, it is a highly valued qualification not only for those looking to pursue a career in the creative arts, but also for those interested in fields such as accountancy, law, media or medicine.

The course focusses on the development of three key skills: performing; composing and listening; and appraising. Students will build on their own knowledge of musical theory, gain a solid understanding of the basic principles of performance, refine their practical skills, study and practice composition, and expand their knowledge of music history through listening and appraisal.

Within these areas of study, A Level Music offers students the opportunity to develop their ability to use musical devices and conventions through composition, engage with and increase awareness and appreciation of the diverse heritage of music, and develop critical evaluation skills through appraising their own and others' music.

Students who study A Level Music at Shireland CBSO Academy Sixth Form will have unique access to industry experts and professional musicians who will provide opportunities to further develop their skills in performance and composition through expert masterclasses, tutorials and performance opportunities.

Music Technology

A qualification in Music Technology enables students to form personal and meaningful relationships with music technology through the development of musical knowledge, understanding and skills. These include recording, technology-based composition, listening, analysing and producing. Students will be encouraged to engage with a wide range of music technology techniques and develop an understanding of the historical and cultural contexts of the use of music technology in the creation and production of music.

A qualification in Music Technology also helps to develop students' written, analytical, practical and personal abilities and interests, encourages lifelong learning and provides access to a wide range of career opportunities, both within the creative industries and beyond.

Students who study Music Technology at Shireland CBSO Academy Sixth Form have unique access to industry experts and professional musicians through our partnership with the City of Birmingham Symphony Orchestra, providing opportunities to further develop their skills and knowledge within a live, active, working environment.





Choosing your Subjects:

In conjunction with other academies in Shireland Collegiate Academy Trust, Shireland CBSO Academy can offer a wide range of courses for students to choose from to supplement their music education.

These include:

A Level

Art
Biology
Chemistry
Computer Science
Dance
English Language
English Literature
English Language and Literature
Geography
Further Maths
German
History
Mathematics
Music
Philosophy, Ethics and Religion
Photography
Physics
Product Design
Psychology
Sociology
Textiles
Travel and Tourism

BTEC

Applied Criminology
Applied Human Biology
Applied Science
Business Studies
Drama RSL (Level 3 Diploma in Creative and Performing Arts)
Health and Social Care
Information Technology
Music Technology
Psychology
Sport

Your Application Timeline

Once you have decided that Shireland CBSO Academy Sixth Form is the right place for you, you are then ready to apply. Below shows a timeline of the application process.



November 2022

Complete your application form. This should be done online by visiting our website: shirelandcbsso.org.uk. The online application form requires information about you, contact details and the courses you are interested in.



Early 2023

Attend your consultation evening appointment. We aim to ensure that you are well supported throughout your application. As part of this, we invite you and your family to attend a consultation evening to discuss your choices and offer advice and guidance. This is not an interview. Following your consultation evening appointment, we will send you a conditional offer letter.



May to June 2023

GCSE exam season!



June 2023

Attend our induction programme to meet your new teachers, new classmates and start your academic studies.



24 August 2023

GCSE Results Day! Once you have collected your results, you can then come and enrol with us. Here we will confirm your subject choices. If you don't meet the entry requirements, we will look at what other courses we can offer you, subject to availability.



September 2023

Your academic studies in Sixth Form begin!





SHIRELAND CBSO ACADEMY

PROUDLY PART OF



Innovate
Inspire
Collaborate



Shireland CBSO Academy
c/o Shireland Collegiate Academy Trust
Waterloo Road
Smethwick
B66 4ND

shirelandcbsso.org.uk
info@scbsso.shirelandcat.net

